

Hob Mounted Sink Sets

Hob mounted sink sets offered by BRITEX have been selected to complement specific stainless steel sinks, troughs and basins within the Britex range. The hob mounted sink sets we supply are sourced from Galvin Engineering - one of Australia's most respected manufacturers of commercial tapware. Hob mounted sink sets are supplied with anti-vandal handles and a heavy duty CP finish with fixed or swivel type spouts. These taps are particularly suited to education projects and public amenities. We are proud to offer these premium quality taps in conjunction with our own first class fixtures.



TW-SET-02

Basin Mounted Set with Fixed Spout

Versatile basin set frequently used on wash troughs and hand basins in education and commercial projects.

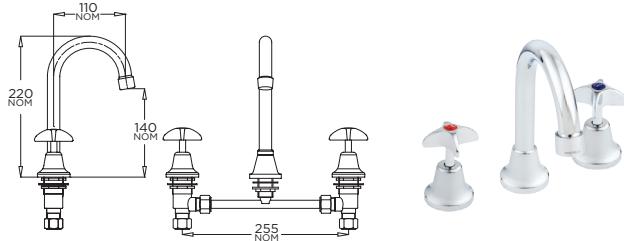

TW-SET-03

Hob Sink Set with Swivel Gooseneck

Sink set with high arc, swivel gooseneck, particularly suited to stainless steel troughs, basins and laundry tubs.

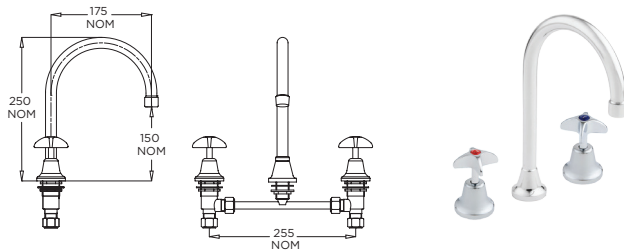

Hob Mounted Mixer Taps

Hob mounted mixer taps offered by BRITEX have been selected to complement specific stainless steel basins, sinks and troughs within the Britex range. The hob mounted mixer taps we supply are commercial quality, have a heavy duty CP finish and are both WELS and WaterMark certified. A lever mixer tap is available for use in disabled amenities in conjunction with our disabled wash basin (HBDA). These taps are particularly suited to public amenities and education projects. We are proud to offer these premium quality taps in conjunction with our own first class fixtures.



TW-MIX-01

Basin Mounted Flick Mixer - Fixed

Stylish, commercial quality basin mounted flick mixer with fixed spout. Cast solid DR brass body. WELS 4 Star, 7.5 litre rating.

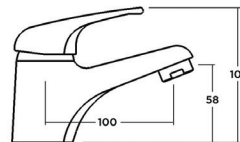

TW-MIX-02

Basin Mounted Flick Mixer - Swivel

Versatile, basin mounted flick mixer with swivel-type spout. WELS 4 Star, 7.5 litre rating.

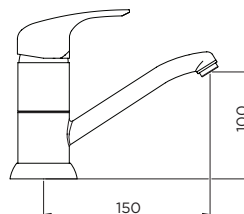

TW-MIX-L

Basin Mounted Lever Mixer

The AS/NZS 3718 WaterMark approved sink mixer is supplied standard with a 185mm long lever handle finished in a bright chrome plate.

Maximum Operating temperature range: 80°CMin/Max
 Operating pressure range: 150 - 500kPa
 Inlet connection: 15mm (1/2") BSP. (Flexitails)
 Inlet pressure range: 150-1000kPa

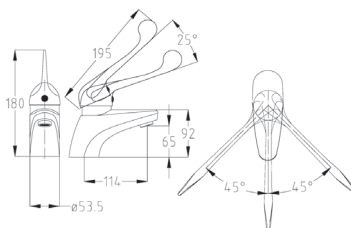

VISIT BRITEX.COM.AU TO DOWNLOAD BIM FILES, CAD DRAWINGS AND THE MOST CURRENT PRODUCT LITERATURE.

Last Revised 2019