

SECURITY HAND WASH BASIN

6.02

HAND BASINS

#SHB / SECURITY HAND WASH BASIN



Scan QR code
to view online



Image shows Model SHB-RF-TW-SEC-01
Security Hand Wash Basin, Rear Fixed with Security Tap Set

features and benefits

- 1.6mm Grade 304 Satin Stainless Steel
- Highly vandal resistant
- Fully welded, seamless construction
- P trap installation
- Completely concealed plumbing
- No sharp edges or corners
- 11 litre bowl capacity
- Recessed area around bowl
- Stylish, modern design
- 40mm waste outlet
- 1, 2 or 3 tap holes
- Choice of tapware styles
- Front and rear fixed models
- Optional anti-ligature waste
- Suits detention projects, holding cells, public amenities and bars

about

The **BRITEX Stainless Steel Security Hand Wash Basin** combines maximum security vandal resistance with quality workmanship and style. Key to its design is a fully welded, radiused front edge with rolled safety fascia. A rounded profile above and below the basin also ensures there are no ligature points and all fixing points are concealed. Plumbing connections are secure within the stainless steel shroud that can incorporate an access panel if fixing from the front and an anti-ligature security waste is optional. Can be supplied with anti-vandal timed flow pillar tap, sensor tap or security tapware for maximum vandal resistance.

sample spec. text

BRITEX S.S. Security Hand Wash Basin - 510L x 415W x 355D. 11 Litre bowl capacity. *Front/Rear fixed model.* Complete with rolled safety fascia, 40mm *security/polypropylene* waste outlet *and XXXX tapware* - Product Code SHB-XX-TW-XXXX

NB Please refer to reverse page for tapware and basin options

*RED TEXT may denote a **variable** where one option only is to be selected, a **nominal dimension** that needs to be specified, or an **optional feature** that can be removed if not required. Please refer to the back of this page for additional specification details and options.

VISIT BRITEX.COM.AU TO DOWNLOAD BIM FILES, CAD DRAWINGS AND THE MOST CURRENT PRODUCT LITERATURE.



MELBOURNE
Britex Place, Mirra Crt
Bundoora VIC 3083
t (03) 9466 9000
f (03) 9466 9044

SYDNEY
16 Northumberland Drv
Taren Point NSW 2229
t (02) 9531 2100
f (02) 9531 2800

PERTH
14 Capital Rd
Malaga WA 6090
t (08) 9249 5464
f (08) 9248 6893

BRISBANE
19 Manila St
East Brisbane QLD 4169
t (07) 3363 2400
f (07) 3363 2444

ADELAIDE
The Britex Group
SA State Office
t 1300 764 744
f 1300 784 306

britex.com.au | info@britex.com.au | A.B.N 83 004 309 737

SECURITY HAND WASH BASIN

PRODUCT CODE

SHB Basin only

HOW TO SPECIFY: Security Hand Wash Basin

Sample Specification Code

A **B** **C**
SHB - RF - TW-SEC-01

= Security Hand Wash Basin, Rear Fixed with Security Tap Set (Cold only)

Specification Key

A = Product Code

B = Fixing Method

RF : Rear Fixed
(no access panel)

FF : Front Fixed
(left hand access panel)

C = Tapware - if required
(see below for suggested tapware options)

Suggested Tapware Options:

(see Tapware Section: 11 for complete range of options)



TW-SEC-01
Security Tap Set
(Cold Only)



TW-SEC-02
Security Tap Set
(Hot & Cold)

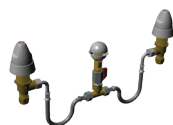

TW-SEC-06
Security 3/4 Turn
Basin Set (Hot & Cold)



TW-9101
Eco Timed Flow
Pillar Tap



TW-9201
Deluxe Timed Flow
Pillar Tap



TW-9204
Deluxe Timed Flow
Pillar Tap

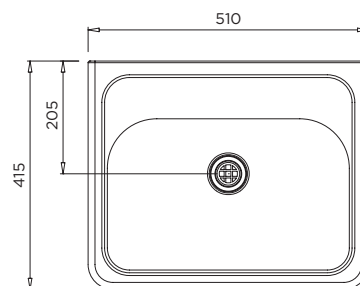

MODEL SHB Plan

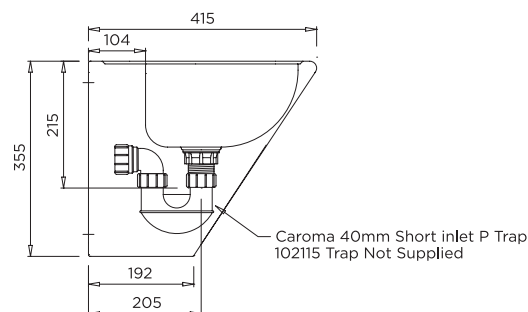

MODEL SHB Side Elevation

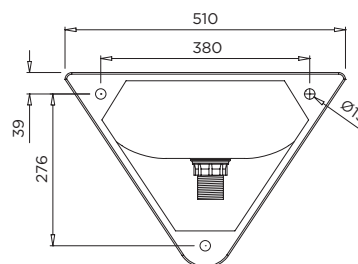

MODEL SHB Rear Elevation

When specifying this product please include:

- Product **Name** and **Code**
- Product **Dimensions**
- **Tapware** details (if required)
- **Fixing Method** - Front or Rear
- **Waste Type** - Standard or Security

specifying
guide

options

- Tap holes
- Tapware - see Tapware Section: 11
- Anti-ligature security waste
- Right/left hand access panel



VISIT BRITEX.COM.AU TO DOWNLOAD BIM FILES, CAD DRAWINGS AND THE MOST CURRENT PRODUCT LITERATURE.

Last Revised June 2017



Due to ongoing research and our commitment to product development, details are subject to change without notice. Details accurate at time of print. Please refer to britex.com.au for the most current product information. Allow +/- 5mm tolerance for dimensions and setouts shown in product literature.

britex.com.au | info@britex.com.au | A.B.N 83 004 309 737

