

UBW

*Barren Waterless
Urinal*

**Installation
Guide**

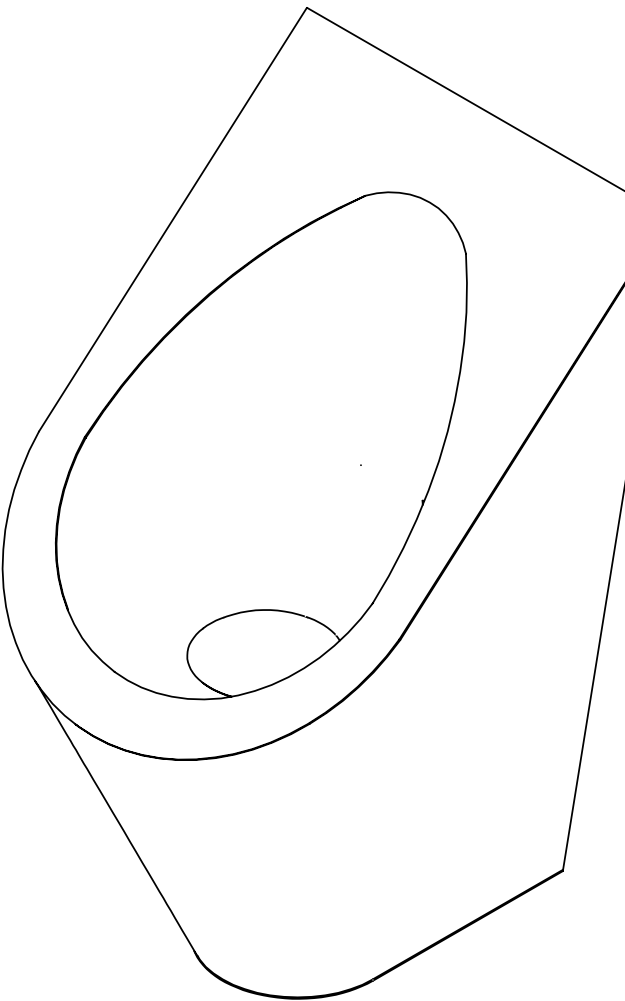

MELBOURNE
BriteX Place Mira Crt
Bundoora VIC 3083
t (03) 9466 9000
e vic@briteX.com.au

SYDNEY
16 Northumberland Drv
Taren Point NSW 2229
t (02) 9531 2100
e nsw@briteX.com.au

PERTH
Unit 1/8 Principal Link
Mallaga WA 6090
t (08) 9249 5464
e wa@briteX.com.au

BRISBANE
19 Manila St
East Brisbane QLD 4169
t (07) 3363 2400
e qld@briteX.com.au

ADELAIDE
The BriteX Group
SA State Office
t 1300 764 744
e sa@briteX.com.au

IMPORTANT

ALL SERVICE TO BE PERFORMED BY AN AUTHORISED SERVICE PERSON

Installation of this unit must be in accordance with AS/NZS 3500.2, the PCA and the local regulatory requirements. Water and/or electrical supply conditions must comply to national or state requirements and standards. Failure to comply shall void the product warranty and may affect the performance of the product. For further support and after-sales care, please contact Britex.

WARNING

WHEN INSTALLATION IS COMPLETE, ENSURE THESE INSTRUCTIONS REMAIN INSIDE THE PLASTIC BAG PROVIDED WITH THE UNIT FOR FUTURE REFERENCE

About

The BRITEX Barren Waterless Urinal is a contemporary looking urinal which provides enormous water saving benefits without compromising on aesthetics. Key to the Barren is its unique outlet that requires no costly replaceable cartridge, sealant fluid or biological block. Instead, the Barren utilises a self-sealing one-way diaphragm that allows urine to pass, whilst trapping odours within the plumbing. Robust in construction but sleek in profile, the Barren Waterless Urinal is highly vandal resistant, easily retrofitted and is also available in an Auto Clean model with timer-activated cleansing device. Perfect for public toilets, clubs and hotels. WaterMark certified as required by plumbing regulations.

Britex Waterless and Limited Flush Urinals

Britex Waterless & Limited Flush Urinals are Australian products, designed and manufactured to operate within the harsh conditions found throughout Australia and within similar climates throughout the world.

Unlike most waterless urinals on the market today, Britex Waterless & Limited Flush Urinals do not require constant maintenance of messy cartridge's which require regular replacement or chemical replenishment to be effective. Instead, Britex Waterless & Limited Flush Urinals utilise a self-sealing, one way diaphragm that allows urine to pass, whilst trapping all odours within the sanitary system.

A realistic approach in the design concept of Britex Waterless Urinals was taken, so as not to fall into the trap so many other manufacturers have experienced. Britex Waterless Urinals are not waterless in the true sense and depend on fresh water cleaning to balance functionality and efficiency. Therefore, as with all urinals and in line with good hygiene practices, regular cleaning is essential to remove struvite, (Urine Crystallisation, commonly yellowish to brownish in colour), calcium phosphate and magnesium precipitation from the surface of the urinal and within sanitary pipes.

Whilst maintaining the goal for water conservation in hand with a realistic and practical approach in maintaining hygiene standards and eliminating plumbing issues, Britex also provides "Mist" and "Auto Mist" models for all waterless urinals, to assist in regular water dosing. The Mist model is supplied with a water connection only whilst the Auto Mist is supplied with a Britex Hygiene Clean which provides an automatic periodic 0.5L burst of water mist over the urinal wall. This common sense feature, which conforms to the highest water saving standards for waterless urinals, removes many of the messy complexities that contribute to odour from exposed surface areas associated with no flush urinals and it also assists with pipe cleaning.

UBW Drawing

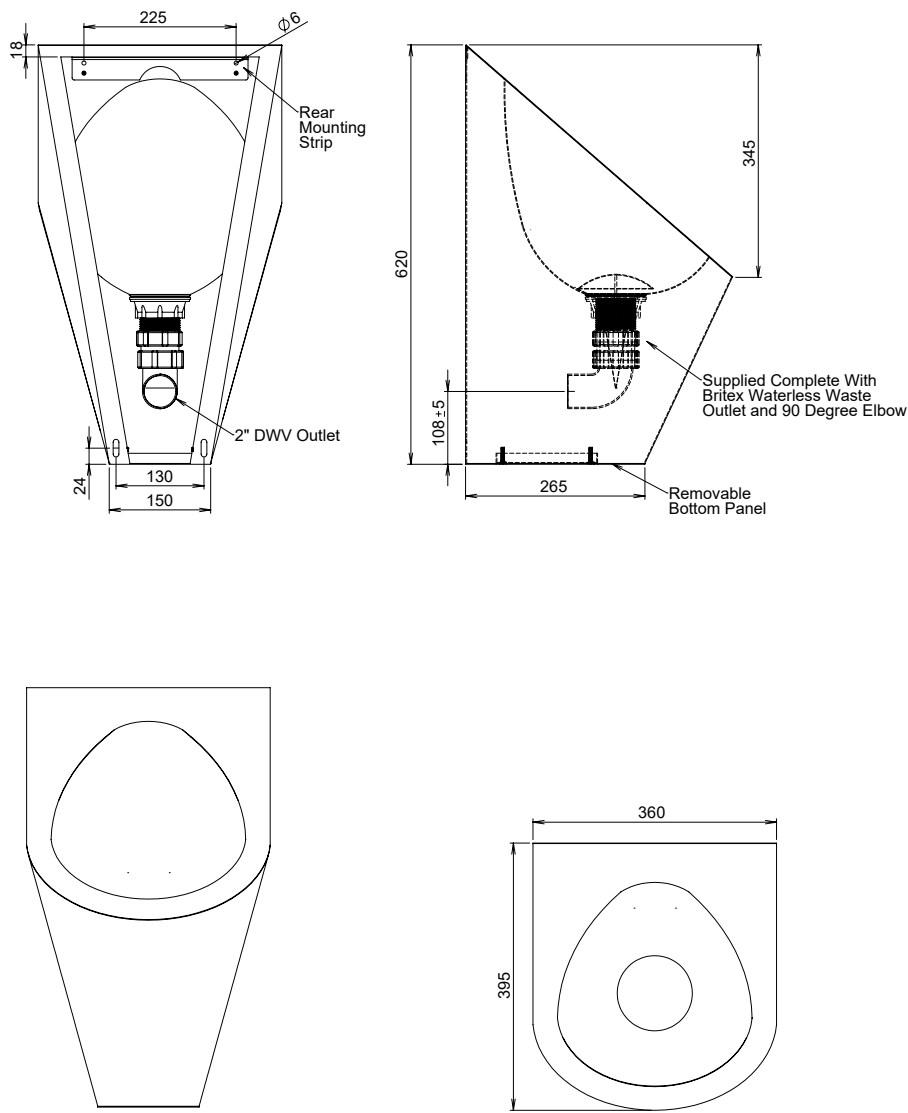

Installation Instructions

1. Once the unit has been pulled out of the box ensure there is no damage to the unit if there is notify Britex immediately.

2. The box should have the following components in it, the UBW unit that includes the 50mm waste, a joggle strip and two screws to secure that to the wall. There are two masonry bolts provided, but the plumber would need to use the appropriate fixings.

3. Dimension from finished floor to front edge/rim of urinal. The suggested mounting heights for Adults is 610mm and for Juniors 510mm.

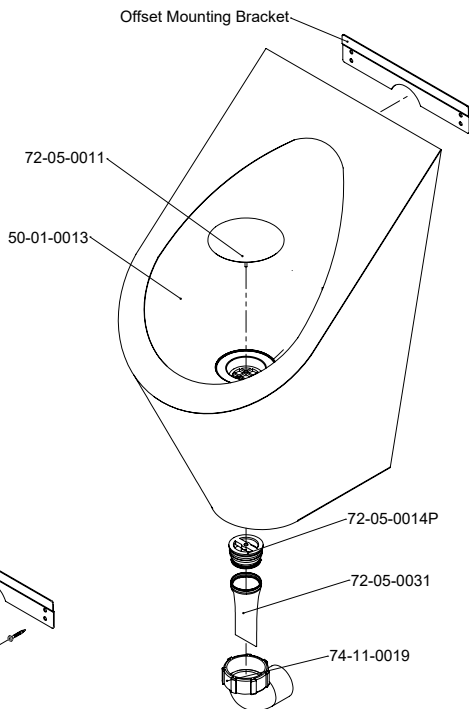
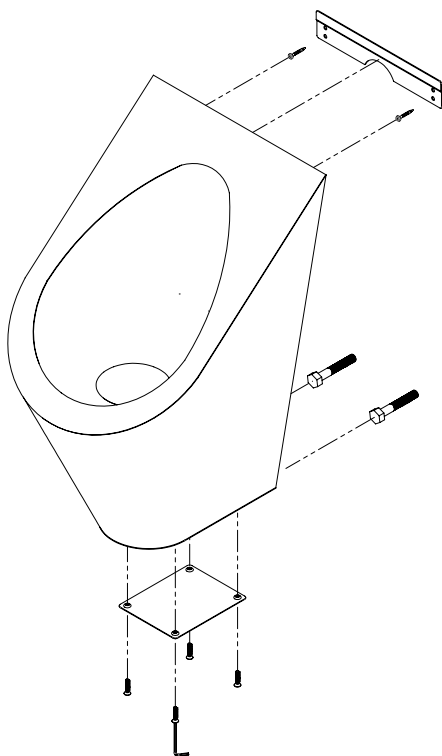

Note: Heights are suggestions only, subject to suitability of users for each individual project.

4. Urinal is fixed to the rear wall across top axis with an offset bracket that is supplied, measure the height required and attached the joggle strip to the wall noggin.

5. Place the UBW on the joggle strip and fix the bottom of the unit using appropriate fixings.

6. Ensure the cleaning of the unit is carried out according to the instruction given below.

Waterless Diaphragm Care and Maintenance

A key element of the Britex waterless urinals is the simplicity of the one-way waterless diaphragm outlet utilised within the design of the urinals which prevents odour dissemination. The life span of the diaphragm will last several years if the following maintenance procedures are sustained.

1. Ensure that the stainless steel dome covering the outlet of the urinal is adjusted down correctly allowing only a small space between the dome and urinal for liquid to pass. A space no greater than 1.5mm is recommended. This will then contain any foreign matter within the urinal that can be removed within the cleaning process. A large space between the outlet dome and the urinal will allow foreign matter to pass and lodge within the diaphragm. This then prevents the diaphragm from closing properly, causing further obstructions and the release of odour from the drainage pipes.

2. Alkaline chemicals (Bleach or Hydrochloric) should not be used to clean the urinal. Do not tip cleaning chemicals or mop bucket water down the outlet of the urinal. Alkaline chemicals will break down the composition of the diaphragm causing the diaphragm to lose its memory. The presence of alkaline chemicals passing through the diaphragm is usually indicated by the diaphragm resembling distortion as if it has been subjected to heat and / or being very sticky. Should this occur then the diaphragm outlet needs to be replaced.

3. If the urinal has not been fitted with a limited flushing device or Hygiene Clean, then the urinal should be sluiced with a warm bucket of water at least once a week to aid in the removal of struvite and calcium phosphate within sanitary pipes

Spare Parts



72-05-0014P

Waterless Outlet (ABS) with Cross Bar and Brass Threaded Insert



72-05-0031

Trap Bladder Waterless Silicone White 40mm



72-05-0011

Dome

Cleaning of Waste Fittings and Branch Piping

As with any urinal, proper cleaning is important to keep the urinal clean and to prevent stains and struvite from forming. Although Britex urinals have a recommendation to be regularly sluiced with water, significantly reducing common occurrences of struvite and calcification, there is still the potential for hidden pipe work to be affected. Calcium and magnesium-based minerals and salts can precipitate and build up in the pipes and fittings, the severity dependent on the pipe lengths and configuration. To reduce the risk of blockages, it is recommended that the following procedure is carried out once every six months to remove internal pipe calcification.

1. Ensure that eye protection, rubber gloves and a vapour mask are worn to perform the following procedure.

2. Remove the waterless diaphragm assembly as per item 1 - 2 within the "Replacing the Diaphragm Assembly" instructions above and put to one side.

3. Mix a 2-litre solution of caustic soda solution (2 parts water to 1 part caustic soda). Pre-mixed solutions are available from certain retailers.

4. Taking care not to flood the urinal with the solution, pour the solution directly into the urinal outlet.

5. Leave for approximately 15 minutes and then pour a generous bucket of fresh water down the outlet.

6. It is imperative that all traces of the caustic soda solution are removed from the surface of the urinal. Clean the urinal as per the cleaning instructions above with a soft cloth or soft bristled brush, ensuring that repetitive sluicing with fresh water removes all traces of the caustic soda solution.

7. Replace the waterless diaphragm assembly as per item 4 - 6 within the "Replacing the Diaphragm Assembly" instructions above. If regular maintenance procedures for waterless urinals have not been conducted on a regular basis and / or blockages are present within pipe configurations, then manual removal of calcification within pipes and fittings will need to be performed by qualified personnel.

Replacing the Diaphragm Assembly

Should the waste diaphragm require replacement, then it is recommended that eye protection and rubber gloves are worn to perform the following procedure.

1. Unscrew the stainless-steel dome allowing adequate room for a firm grasp to be placed around the dome.

2. Apply an upward pressure to lift the dome, breaking the "o" ring seal removing the diaphragm assembly.

3. Unscrew the dome from the boss and discard the diaphragm assembly.

4. Screw the dome into the new diaphragm assembly boss and then place the new diaphragm into the waste housing, applying gentle pressure to ensure that it is seated correctly.

5. Screw the dome down and back into position ensuring a gap of no more than 1.5mm. The lock nut on the stud of the dome may need to be adjusted to achieve the 1.5mm gap. **6.** Pour clean water into the urinal to test the outlet.

Care and Maintenance

Stainless steel products should be kept clean at all times. The secret to stainless steel's ability to maintain a high quality finish and promises of a long life expectancy is the invisible chromium-oxide film that sits on the surface and protects the steel beneath. To maintain this film it is essential that the surface remains clean and in constant contact with oxygen. If this film is penetrated (either by abrasion or chemically) and dirt, liquid, grime contaminants embed themselves in these micro chasms for an extended period of time, the chromiumoxide film will not be able to regenerate and the steel below will eventually become damaged and discoloured.

What we recommend for general cleaning and maintenance:

Cleaning Materials:

- A soft cloth
- A soft-bristled brush
- A natural or artificial sponge

Cleaning Solutions:

- Hand washing soap / soft water solution
- Mild soap / soft water solution
- White vinegar / soft water solution

It is recommended that general cleaning of stainless steel surfaces be carried out weekly, or as soon as a build up of surface media has been observed. To clean, simply wash stainless steel surfaces with, warm, diluted, mild soapy water using a cloth or soft bristled brush. Once all dirt, oil and grime is removed, rinse thoroughly with clean water and wipe dry.

Warranty

The BRITEX product is backed by our manufacturer's warranty available for download from our website at www.britex.com.au. We expressly warrant that the product is free from operational defects in workmanship and materials for the warranty period indicated on the schedule in the manufacturer's warranty. During the warranty period, BRITEX will repair or replace any defective products manufactured by BRITEX at no charge, provided that the terms of the manufacturer's warranty are followed.

This warranty is the only warranty given by BRITEX, and we expressly disclaim all other warranties, including but not limited to implied warranties of merchantability and fitness for a particular purpose. This warranty represents the sole and exclusive remedy for breach of warranty, and BRITEX shall not be liable for any incidental, special, or consequential damages, including lost profits, labor charges, delays, vandalism, negligence, fouling caused by foreign material, damage from adverse water conditions, chemical, electrical or any other circumstances beyond BRITEX's control.

This warranty shall be void if the product is abused, misused, improperly installed, maintained, or altered. By purchasing our product, you agree to these terms and conditions. We appreciate your business and look forward to providing you with high-quality products and services.

