

# STAINLESS STEEL WASH SAFE™ BASIN MIXER WITH ACCESSIBLE LEVER

TAPWARE

#TW-MIX-L-SS / STAINLESS STEEL WASH SAFE™ BASIN MIXER

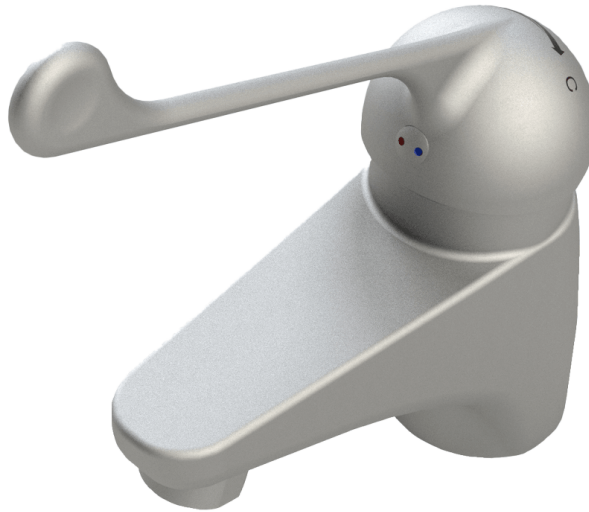

## features and benefits

- 304 stainless steel construction
- Complies to Victorian School Building Authority (VSBA)
- Ergonomic design
- AS 1428.1 accessible compliant
- WaterMark and WELS certified
- Low lead DZR Brass

## about

Accessible mixer taps offered by BRITEX have been selected to work in conjunction with BRITEX accessible basins. The mixer tap with accessible lever are made with 304 stainless steel and complies to Victorian School Building Authority (VSBA) and is AS1428.1 accessible compliant. The mixer has an ergonomic design and brushed stainless steel finish and are both WELS and WaterMark certified. These taps are particularly suited to public amenities and education projects.

## sample spec. text

*Britex Stainless Steel Wash Safe™ Basin Mixer with Accessible Lever - Product Code: TW-MIX-L-SS*

\*RED TEXT may denote a **variable** where one option only is to be selected, a **nominal dimension** that needs to be specified, or an **optional feature** that can be removed if not required. Please refer to the back of this page for additional specification details and options.

VISIT [BRITEX.COM.AU](http://BRITEX.COM.AU) TO DOWNLOAD BIM FILES, CAD DRAWINGS AND THE MOST CURRENT PRODUCT LITERATURE.



**MELBOURNE**  
Britex Place, Mirra Crt  
Bundoora VIC 3083  
t (03) 9466 9000  
f (03) 9466 9044

**SYDNEY**  
16 Northumberland Drv  
Taren Point NSW 2229  
t (02) 9531 2100  
f (02) 9531 2800

**PERTH**  
Unit 1/8 Principal Link  
Malaga WA 6090  
t (08) 9249 5464  
f (08) 9248 6893

**BRISBANE**  
19 Manilla St  
East Brisbane QLD 4169  
t (07) 3363 2400  
f (07) 3363 2444

**ADELAIDE**  
The Britex Group  
SA State Office  
t 1300 764 744  
f 1300 784 306

[britex.com.au](http://britex.com.au) | [sales@britex.com.au](mailto:sales@britex.com.au) | A.B.N 83 004 309 737

# STAINLESS STEEL WASH SAFE™ BASIN MIXER WITH ACCESSIBLE LEVER

PRODUCT CODE

## TW-MIX-L-SS



technical  
information

**WELS:** 6 Star Rating (4.0L/min) or 5 Star Rating (6.0L/min)

**Nominal Flow Rate (LPM):** 3.80 or 5.88

**WaterMark:** AS/NZS 3718 Lic. WM-021226

**Inlet:** 1/2" BSP - Female Flexi Tails

**Outlet:** Aerator

**Headwork:** 40mm Ceramic Cartridge

**Working Pressure Range (kPa):** 20 Min - 500 Max

**Working Temperature Range (°C):** 5 Min - 80 Max

**Construction:** 304 Stainless Steel

**Finish:** Brushed Stainless Steel

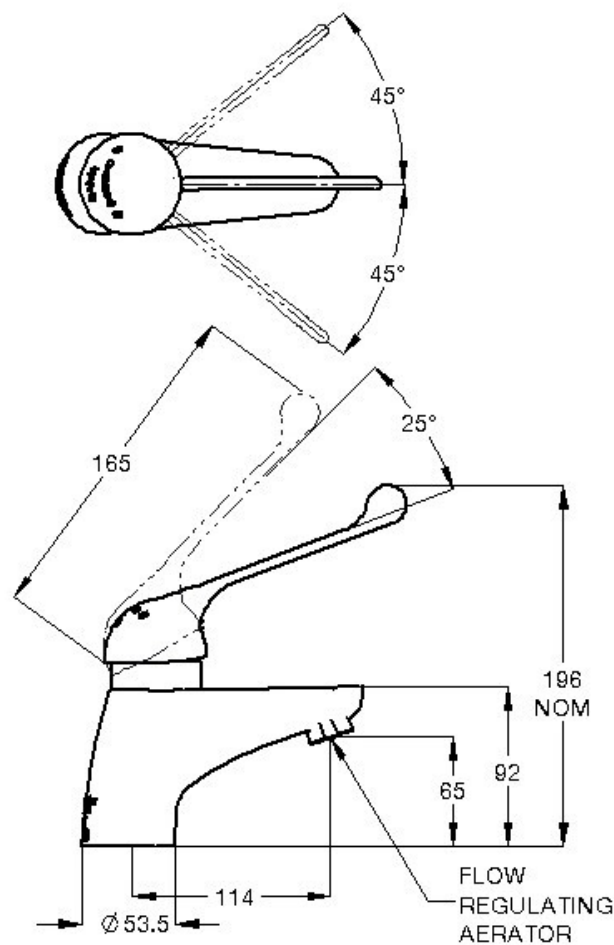

specifying  
guide

*When specifying this product please include:*

- Product Name and Code

VISIT [BRITEX.COM.AU](http://BRITEX.COM.AU) TO DOWNLOAD BIM FILES, CAD DRAWINGS AND THE MOST CURRENT PRODUCT LITERATURE.

Last Revised Jan 2024



Due to ongoing research and our commitment to product development, details are subject to change without notice. Details accurate at time of print.

Please refer to [britex.com.au](http://britex.com.au) for the most current product information. Allow +/- 5mm tolerance for dimensions and setouts shown in product literature.

[britex.com.au](http://britex.com.au) | [sales@britex.com.au](mailto:sales@britex.com.au) | A.B.N 83 004 309 737

