

LABORATORY TAP SET 7



features and benefits

- WELS and WaterMark certified
- Australian made
- Premium quality
- Choice of outlet type
- Single dual temperature sets
- Heavy duty CP finish
- Robust construction

about

Laboratory taps offered by BRITEX have been selected to complement specific stainless steel basins, sinks and troughs within the Britex range. Laboratory tapware is supplied with a heavy duty CP finish in a wide range of formats with XT tube nozzles or aerators, fixed and swivel spouts in single and dual temperature options. These taps are particularly suited to laboratories, testing facilities and education projects. We are proud to offer these premium quality taps in conjunction with our own first class fixtures.

sample spec. text

Britex Laboratory Tap Set 7 - Product Code: TW-LBSET-07

*RED TEXT may denote a **variable** where one option only is to be selected, a **nominal dimension** that needs to be specified, or an **optional feature** that can be removed if not required. Please refer to the back of this page for additional specification details and options.

VISIT BRITEX.COM.AU TO DOWNLOAD BIM FILES, CAD DRAWINGS AND THE MOST CURRENT PRODUCT LITERATURE.



MELBOURNE
Britex Place, Mirra Crt
Bundoora VIC 3083
t (03) 9466 9000
f (03) 9466 9044

SYDNEY
16 Northumberland Drv
Taren Point NSW 2229
t (02) 9531 2100
f (02) 9531 2800

PERTH
Unit 1/8 Principal Link
Malaga WA 6090
t (08) 9249 5464
f (08) 9248 6893

BRISBANE
19 Manilla St
East Brisbane QLD 4169
t (07) 3363 2400
f (07) 3363 2444

ADELAIDE
The Britex Group
SA State Office
t 1300 764 744
f 1300 784 306

britex.com.au | sales@britex.com.au | A.B.N 83 004 309 737

LABORATORY TAP SET 7

PRODUCT CODE

TW-LBSET-07



WELS: 6 Star (4.5L/min) or 5 Star Rating (5.5L/min)
Nominal Flow Rate (LPM): 4.36 or 5.0
WaterMark: AS/NZS 3718 Lic. WMKA0034
Inlet: 1/2" BSP Male
Outlet: Aerator
Headwork: Jumper Valve
Working Pressure Range (kPa): 50 Min - 500 Max
Operating Temperature Range (°C): 5 Min - 65 Max
Construction: Brass
Finish: Chrome

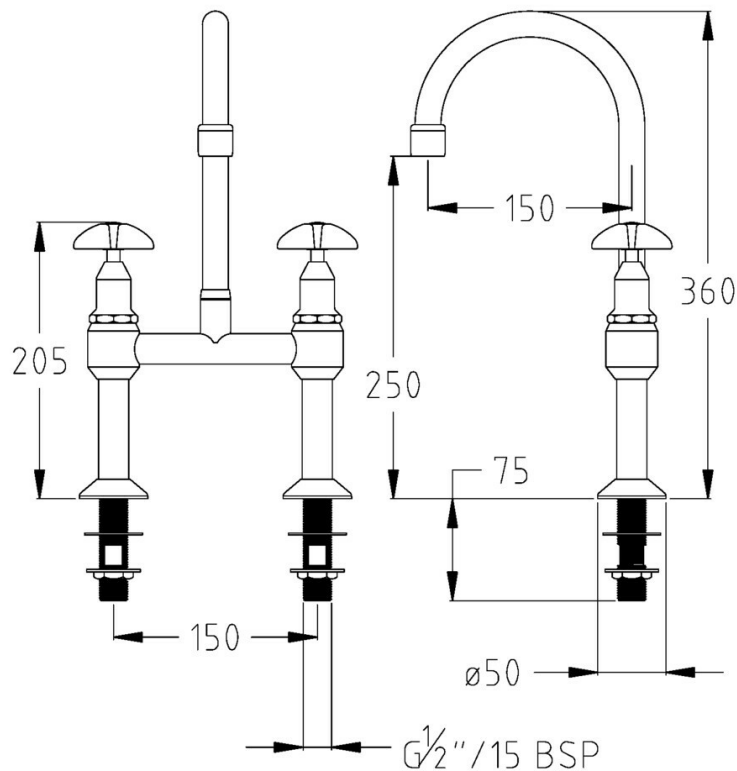

When specifying this product please include:

- Product Name and Code

VISIT BRITEX.COM.AU TO DOWNLOAD BIM FILES, CAD DRAWINGS AND THE MOST CURRENT PRODUCT LITERATURE.

Last Revised Dec 2023



Due to ongoing research and our commitment to product development, details are subject to change without notice. Details accurate at time of print. Please refer to britex.com.au for the most current product information. Allow +/- 5mm tolerance for dimensions and setouts shown in product literature.

britex.com.au | sales@britex.com.au | A.B.N 83 004 309 737

