

# Installation Guide

## Product Code:

TW-9103

## Product Name:

Timed Flow Lever Pillar Tap

European made, anti-vandal timed flow pillar taps supplied for use in conjunction with BRITEX troughs, basins and sinks. Ideal for public spaces and education facilities.

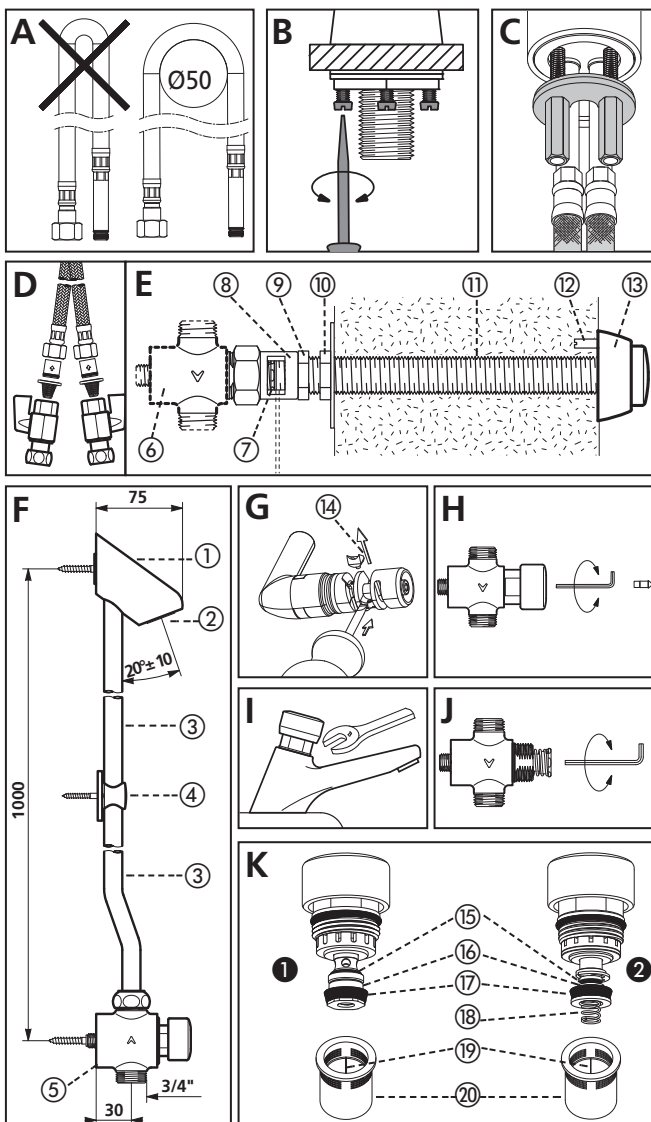

## OPERATION

EN

- Valve opens by pressing on the push-button or pushing the lever.
- AB Model: valve opens by pressing then releasing the push-button.
- Mixer: temperature selection by the side lever.
- Automatic shut-off after ~7 seconds for washbasins, ~3 seconds or 7 seconds for urinals (depending on the model), and ~30 seconds for showers (+5/-10 at 3 bar according to the European Standard EN-NF 816).
- (Other shut-off delays: TEMPOSTOP swan neck ~3 seconds, TEMPOSTOP chain-pull shower and TEMPOSTOP shower 1/2" ~15 seconds).

## INSTALLATION

- Tap: supply with cold water (insert the blue or grey marker) or mixed water (insert the red marker).
- Mixer: supply with cold water and hot water at 50°C (maximum recommended 70°C), and balance hot and cold water pressure ( $\Delta P < 1$  bar). Maximum pressure: 10 bar. Recommended dynamic pressure: 1 - 5 bar. Take care not to pinch the flexibles (Fig. A).
- Respect the direction of the water flow, see arrow marked on the valve body.

### Deck-mounted washbasin model

- Drill hole diameter:  $\varnothing 21$ mm for taps or  $\varnothing 34$ mm for mixers.
- Mount the mixer/tap body onto the washbasin and tighten the nuts:
  - Model with back-nut: tighten the 3 stainless steel screws on the back-nut (Fig. B).
  - Mixer: tighten the nuts (Fig. C) onto the fixing flange. Install the filters (Fig. D) supplied as shown in the diagram. They will protect the non-return valves.
- Ensure a suitable waterproof seal between the mixer/tap and the work plan appropriate to the type of installation.
- Connect the water supply and activate the valve several times to stabilise the timing.