

PWD PRE PLUMBED DRINKING TROUGH

4.01

TROUGHS

#TPWDPD / PWD PRE-PLUMBED DRINKING TROUGH



Choose from 3 bubbler activation types:

Lever Action, Cam Action, or Push Button

(Image shows Push Button style for indicative purposes only)

features and benefits

- Supplied pre-plumbed. Just connect water and waste outlet
- 1.2mm Grade 304 Stainless Steel
- Choice of button/lever/cam activated bubblers with rubber compound mouth-guards to protect teeth
- WELS and WaterMark certified, sun-light and bacteria resistant tapware
- 50mm waste & wall brackets supplied
- Concealed tapware connections
- Left or right hand waste position
- Radius internal corners - easy cleaning
- Radius external corners - added safety
- Ideal for schools, kindergartens and child care

about

The *BRITEX Stainless Steel PWD Pre-Plumbed Drinking Trough* comes complete with a choice of Watermark and WELS certified drinking bubblers pre-installed. Fully welded, rounded corners both internally and externally ensure easy cleaning and provide added safety in high traffic areas. Water efficient drink bubblers feature bacteria and sunlight resistant rubber compound mouth pieces for additional safety in the event users are bumped whilst drinking. A 50mm hob in the rear splashback allows for the pre-installed plumbing to be concealed and resistant to vandalism. Supplied complete with 50mm waste outlet and heavy duty wall brackets.

sample spec. text

BRITEX S.S. Pre-Plumbed Drinking Trough - XXXXmm Long. Complete with wall brackets, X No. Push Button/Cam/Lever activated drinking taps with safety rubber mouth pieces, 50mm left/right waste outlet, radius internal and external bowl corners - Product Code TPWDPD-XXXX-X-TW-XXXX-XX-X

NB Please refer to reverse page for tapware and trough options

*RED TEXT may denote a **variable** where one option only is to be selected, a **nominal dimension** that needs to be specified, or an **optional feature** that can be removed if not required. Please refer to the back of this page for additional specification details and options.

VISIT BRITEX.COM.AU TO DOWNLOAD BIM FILES, CAD DRAWINGS AND THE MOST CURRENT PRODUCT LITERATURE.



MELBOURNE
Britex Place, Mirra Crt
Bundoora VIC 3083
t (03) 9466 9000
f (03) 9466 9044

SYDNEY
16 Northumberland Drv
Taren Point NSW 2229
t (02) 9531 2100
f (02) 9531 2800

PERTH
Unit 1/8 Principal Link
Malaga WA 6090
t (08) 9249 5464
f (08) 9248 6893

BRISBANE
19 Manilla St
East Brisbane QLD 4169
t (07) 3363 2400
f (07) 3363 2444

ADELAIDE
The Britex Group
SA State Office
t 1300 764 744
f 1300 784 306

britex.com.au | sales@britex.com.au | A.B.N 83 004 309 737

PWD PRE-PLUMBED DRINKING TROUGH

PRODUCT CODE

TPWDPD

HOW TO SPECIFY: PWD Drinking Trough (PRE-PLUMBED)

Sample Specification Code

A B C D E F
TPWDPD - 1500 - 3 - TW-DP90 - WB - R

= PWD Pre-Plumbed Drinking Trough with 3 Push Button Bubblers, 1500mm long, Brackets only, Right Hand Waste

Specification Key

A = Product Code

B = Trough Length (mm)

C = Tap Quantity

D = Tap Code
(see below for tapware options)

E = Support Options

WB : Brackets only

BL : Brackets and Legs

F = Waste Outlet Position

L : Left Hand Waste

R : Right Hand Waste

Standards Troughs and Tap Combinations

1200mm - 3 taps

1500mm - 3 taps

1800mm - 4 taps

2400mm - 6 taps

Suggested Mounting Heights (mm)

drink	infant	primary	secondary
	550	700	900

Tapware Options: (please see Tapware datasheet for more details)



Cam Action
TW-DC90



Lever Action
TW-DL90



Push Button
TW-DP90



Bottle Filler
TW-BF-L90

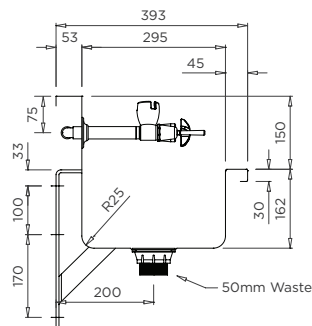

MODEL TPWDPD Section

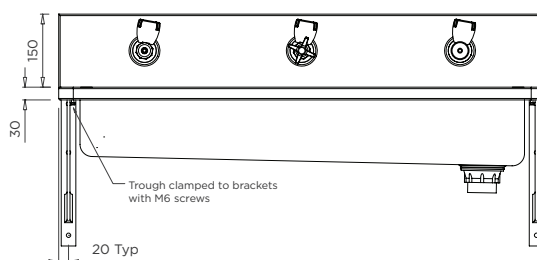

Troughs over 2000mm long are supplied with a centre support bracket

MODEL TPWDPD Front Elevation

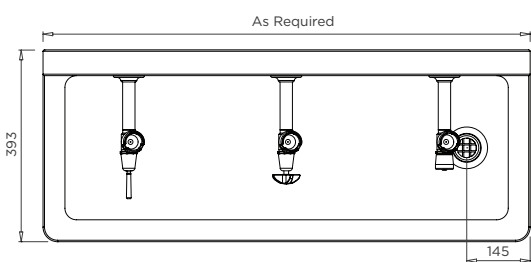

MODEL TPWDPD Plan

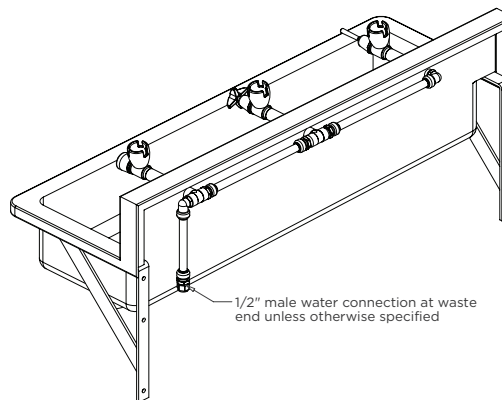

MODEL TPWDPD Rear Isometric View

When specifying this product please include:

- Product **Name** and **Code**
- Product **Dimensions**
- Tap **Quantity** and **Code**
- Position of **Waste Outlet** (left/right)

specifying
guide

options

- Upstand to side(s)
- Support legs
- Custom trough dimensions
- Left or right hand waste
- Custom inlet position
- SS Shroud 450mm

VISIT BRITEX.COM.AU TO DOWNLOAD BIM FILES, CAD DRAWINGS AND THE MOST CURRENT PRODUCT LITERATURE.

Last Revised Sep 2023



Due to ongoing research and our commitment to product development, details are subject to change without notice. Details accurate at time of print. Please refer to britex.com.au for the most current product information. Allow +/- 5mm tolerance for dimensions and setouts shown in product literature.

britex.com.au | sales@britex.com.au | A.B.N 83 004 309 737

