

PEDESTAL SECURITY BASIN

HAND BASINS

#SPB / PEDESTAL SECURITY BASIN



*Image shows Model SPB-RF-TW-SEC-01-T
Pedestal Security Basin Rear Fixed with Security Tap Set and Toilet Roll Holder (optional)*

features and benefits

- 1.6mm Grade 304 Satin Stainless Steel
- Shroud extends to the floor
- 6 litre bowl capacity
- All plumbing connections concealed
- Optional access panel (if front fixed)
- Fixes to floor and rear wall
- 40mm waste outlet supplied
- P or S trap installation
- Optional toilet roll holder
- Choice of tapware styles
- 1, 2 or 3 tap holes
- Optional anti-ligature waste
- Suits detention projects, holding cells, public amenities and bars

about

The *BRITEX Stainless Steel Pedestal Security Basin* is a popular vandal resistant fixture for holding cells, public toilets and train stations. Shrouded all the way to the ground, it can be trapped through the floor, eliminating the need to penetrate the rear wall. Compact in size and taking up little space in smaller rooms, it is fixed both at the rear of the basin and at the base. Options include an integral toilet roll holder, security waste and access panels if fixing from the front. Can be supplied with fully certified timed flow pillar taps or security tapware if required. Security waste is optional.

sample spec. text

*BRITEX S.S. Pedestal Security Basin. 360L x 420W x 820H. **Front/Rear** fixed model, supplied complete with 40mm **security/polypropylene** waste outlet, **integrated toilet roll holder** and **XXXX tapware** - Product Code SPB-XX-TW-XXXX-X*

NB Please refer to reverse page for tapware and basin options

*RED TEXT may denote a **variable** where one option only is to be selected, a **nominal dimension** that needs to be specified, or an **optional feature** that can be removed if not required. Please refer to the back of this page for additional specification details and options.

VISIT BRITEX.COM.AU TO DOWNLOAD BIM FILES, CAD DRAWINGS AND THE MOST CURRENT PRODUCT LITERATURE.



MELBOURNE
Britex Place, Mirra Crt
Bundoora VIC 3083
t (03) 9466 9000
f (03) 9466 9044

SYDNEY
16 Northumberland Drv
Taren Point NSW 2229
t (02) 9531 2100
f (02) 9531 2800

PERTH
14 Capital Rd
Malaga WA 6090
t (08) 9249 5464
f (08) 9248 6893

BRISBANE
19 Manila St
East Brisbane QLD 4169
t (07) 3363 2400
f (07) 3363 2444

ADELAIDE
The Britex Group
SA State Office
t 1300 764 744
f 1300 784 306

britex.com.au | sales@britex.com.au | A.B.N 83 004 309 737

PEDESTAL SECURITY BASIN

PRODUCT CODE

SPB Basin only

HOW TO SPECIFY: Pedestal Security Basin

Sample Specification Code

A B C D
SPB - RF - TW-SEC-01 - T

= Pedestal Security Basin, Rear Fixed with Security Tap Set (Cold) and Toilet Roll Holder

Specification Key

A = Product Code

B = Fixing Method

RF : Rear Fixed

(no access panel)

FF : Front Fixed

(left hand access panel)

C = Tapware - if required
(see below for tapware options)

D = Toilet Roll Holder (opt.)

T : Toilet Roll Holder

N : No Toilet Roll Holder

Suggested Tapware Options:

(see Tapware Section: 11 for complete range of options)



TW-SEC-01
Security Tap Set
(Cold Only)

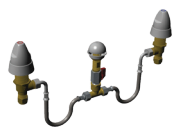

TW-SEC-06
Security 3/4 Turn
Basin Set (Hot & Cold)



TW-9101
Eco Timed Flow
Pillar Tap



TW-MIX-01
Basin Mounted
Flick Mixer



TW-9202
Deluxe Timed Flow
Mixer Tap

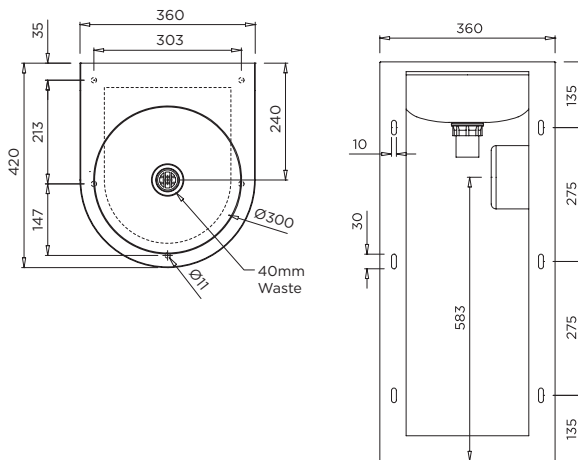

MODEL SPB Rear Elevation and Plan

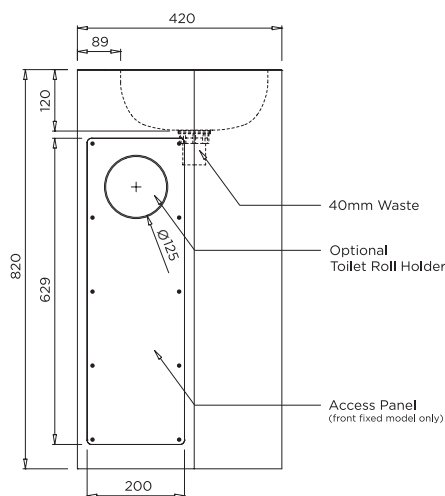

MODEL SPB Side Elevation

When specifying this product please include:

- Product **Name** and **Code**
- Product **Dimensions**
- **Tapware** details (if required)
- **Fixing Method** - Front or Rear
- **Waste Type** - Standard or Security

specifying
guide

options

- Tap holes
- Anti-ligature security waste
- Right/left hand access panel
- Splashback Panel - Up to 500mm High
- Toilet roll holder

VISIT BRITEX.COM.AU TO DOWNLOAD BIM FILES, CAD DRAWINGS AND THE MOST CURRENT PRODUCT LITERATURE.

Last Revised Mar 2023



Due to ongoing research and our commitment to product development, details are subject to change without notice. Details accurate at time of print. Please refer to britex.com.au for the most current product information. Allow +/- 5mm tolerance for dimensions and setouts shown in product literature.

britex.com.au | info@britex.com.au | A.B.N 83 004 309 737

