



Scan QR code  
to view online



## features and benefits

- One piece pressing
- Integral, pressed foot stands
- Vandal resistant
- Can be installed flush or elevated off floor
- Supplied with water spreader

## about

The *BRITEX Stainless Squat Pan* is designed to meet the growing demand for hygienic, vandal resistant sanitary fixtures in facilities catering to multicultural clientele. It can be installed flush with the floor to enable cleaning of the total floor area or on a raised plinth platform to squat.

Please Note: Britex Stainless Steel Squat Pans are intended for sale within the Asia Pacific market and do not currently hold Australian Watermark or WELS certification. If the squat pans are to be purchased and installed within Australia, product approval should be sought from the applicable governing authorities prior to purchase.

## sample spec. text

*BRITEX Stainless Steel Squat Pan - 595 x 625mm O/A - Product Code PSQU*

\*RED TEXT may denote a **variable** where one option only is to be selected, a **nominal dimension** that needs to be specified, or an **optional feature** that can be removed if not required. Please refer to the back of this page for additional specification details and options.

VISIT [BRITEX.COM.AU](http://BRITEX.COM.AU) TO DOWNLOAD BIM FILES, CAD DRAWINGS AND THE MOST CURRENT PRODUCT LITERATURE.

# SQUAT PAN

PRODUCT CODE

## PSQU

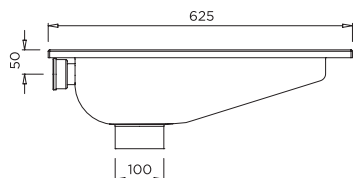

MODEL PSQU Side Elevation

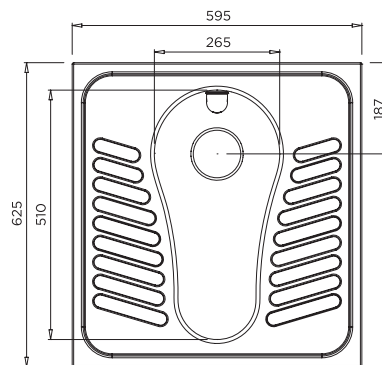

MODEL PSQU Plan

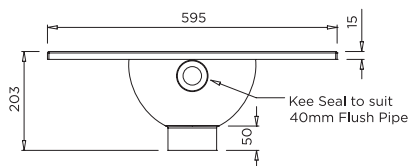

MODEL PSQU Rear Elevation

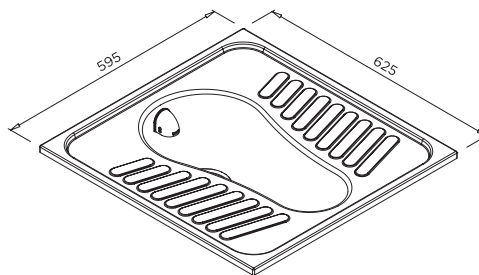

MODEL PSQU Isometric View

*When specifying this product please include:*

- Product **Name** and **Code**
- Product **Dimensions**

specifying  
guide

options

- Britex Cistern - see Flushing Section: 3

VISIT [BRITEX.COM.AU](http://BRITEX.COM.AU) TO DOWNLOAD BIM FILES, CAD DRAWINGS AND THE MOST CURRENT PRODUCT LITERATURE.

Last Revised June 2017