

# CENTURION ACCESSIBLE PAN



WELS REG#  
P Trap: L06697  
S Trap: L06698



N.B: All Britex disabled and ambulant toilet pans are supplied with our Vandal Resistant Closed Front Toilet Seat (black colour unless otherwise specified) to comply with AS1428 Disability Code.

## features and benefits

- WELS and WaterMark certified
- Disability code AS1428 compliant
- Available with S or P trap
- Concealed fixings
- Unique blockage resistant trap
- Safety radius front edges
- Left and right access panels
- Free of ligature points
- Optional backrest - as required by AS1428
- Option for permanently sealed access panels (maximum security projects)
- Option for 'Ambulant' model (raised height only)
- Suits detention facilities and public amenities

## about

The *BRITEX Centurion Disabled Toilet Pan* is fully shrouded and manufactured from heavy gauge 304 satin S.S. making it easy to clean and providing optimal strength. Designed to conform to Australian Standard for disability access - AS1428, the Centurion Disabled Toilet Pan is supplied with a Vandal Resistant Closed Front Toilet Seat (colour to be nominated). Incorporating radius edges for added safety, a pressed internal bowl and unique trap design, the Centurion Disabled pan is extremely water efficient (4.5/3 litre) and much less susceptible to costly blockages in public amenities. Access panels come standard on both sides of the pan for easy installation and a toilet seat can be fitted if required. WaterMark and WELS certified as required by plumbing regulations and government legislation. A vandal resistant Stainless Steel Backrest as required by AS1428:2009 is optional.

## sample spec. text

*BRITEX S.S. Centurion Disabled Toilet Pan - 4\* WELS rating and WaterMark certified. S/P Trap, 14mm safety radius front edge, fully shrouded to rear wall and 2 x access panels. Supplied complete with black vandal resistant toilet seat code SVRC-B. AS 1428 compliant - Product Code PCDX*

\*RED TEXT may denote a **variable** where one option only is to be selected, a **nominal dimension** that needs to be specified, or an **optional feature** that can be removed if not required. Please refer to the back of this page for additional specification details and options.

VISIT [BRITEX.COM.AU](http://BRITEX.COM.AU) TO DOWNLOAD BIM FILES, CAD DRAWINGS AND THE MOST CURRENT PRODUCT LITERATURE.



**MELBOURNE**  
Britex Place, Mirra Crt  
Bundoora VIC 3083  
t (03) 9466 9000  
e vic@britex.com.au

**SYDNEY**  
16 Northumberland Drv  
Taren Point NSW 2229  
t (02) 9531 2100  
e nsw@britex.com.au

**PERTH**  
14 Capital Rd  
Malaga WA 6090  
t (08) 9249 5464  
e wa@britex.com.au

**BRISBANE**  
19 Manila St  
East Brisbane QLD 4169  
t (07) 3363 2400  
e qld@britex.com.au

**ADELAIDE**  
The Britex Group  
SA State Office  
t 1300 764 744  
e sales@britex.com.au

[britex.com.au](http://britex.com.au) | [sales@britex.com.au](mailto:sales@britex.com.au) | A.B.N 83 004 309 737

## PRODUCT CODE

**PCDS** S Trap Model**PCDP** P Trap Model

## MAXIMUM SECURITY MODEL AVAILABLE

Add '-MS' to the end of the above product codes to specify a maximum security, rear access only model supplied with permanently sealed side access panels.

## Suggested Toilet Seat Options:

(see Toilet Seats: 2.18 for complete range of options)



**SVRC-B**  
Vandal Resistant  
Closed Front  
Toilet Seat - BLACK



**SVRC-W**  
Vandal Resistant  
Closed Front  
Toilet Seat - WHITE



**SVRC-N**  
Vandal Resistant  
Closed Front  
Toilet Seat - NAVY

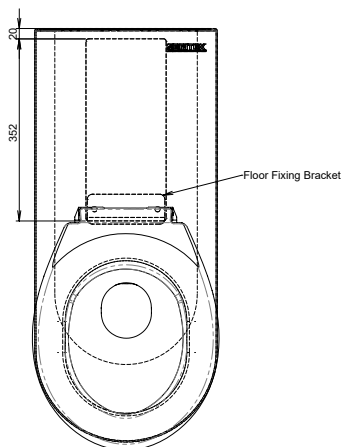

MODEL PCDS / PCDP Plan

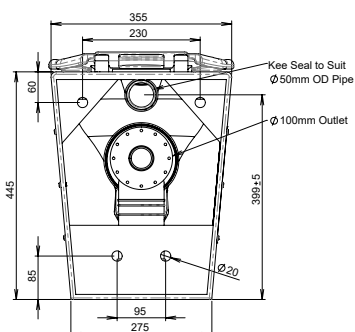

MODEL PCDS Side and Rear Elevation

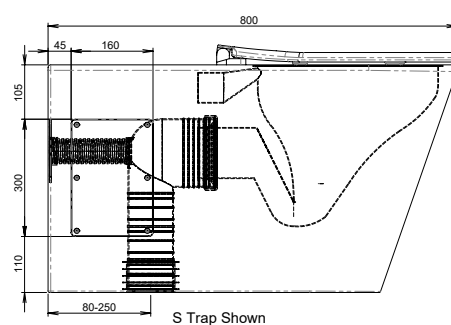

S Trap Shown

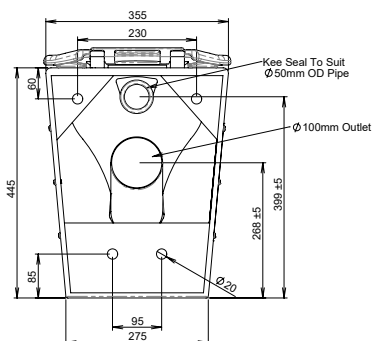

MODEL PCDP Side and Rear Elevation

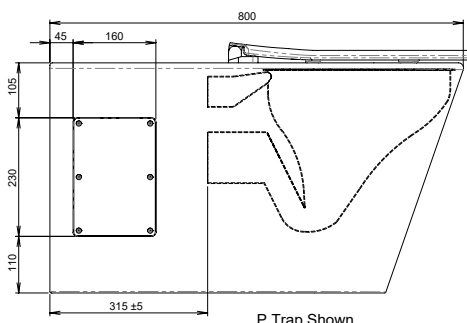

P Trap Shown

## specifying guide

- Product **Name** and **Code**
- Product **Dimensions**
- Product **Features / Options**
- **P** or **S** Trap
- **Seat Model** (if required)

## options

- Toilet Seat see p.2.18
- Backrest - as required by AS1428 see p.2.19
- S or P trap configurations
- Top entry to suit wall mount cistern
- Britex Cistern - see Flushing Section:3
- Permanently sealed access panels for maximum security projects
- Custom material thickness - consult BRITEX

VISIT [BRITEX.COM.AU](http://BRITEX.COM.AU) TO DOWNLOAD BIM FILES, CAD DRAWINGS AND THE MOST CURRENT PRODUCT LITERATURE.

Last Revised Nov 2022 | Revision D