

LABORATORY TAPWARE

Laboratory Sets Type 16

Type 16 laboratory tapware is supplied standard with vandal resistant handle and button, 15mm male BSP inlet and standard jumper valve, finished with a heavy duty, bright chrome plating.



TW-LBSET-01

Lab Set 1-Way Type 16:DOC Fixed Jumper Valve #8 V/R Aerator 5LPM [WELS 5 Star]. Approved to NSW Department of Commerce and is commonly specified for NSW schools.

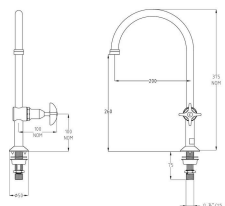

TW-LBSET-01A

Lab Set 1-Way Type 16:DOC Fixed Goose-neck, Jumper Valve #16 XT Tube Nozzle with Integral Mini Dual Check Valve 5LPM [WELS 5 Star]. Approved to NSW Department of Commerce and is commonly specified for NSW schools.

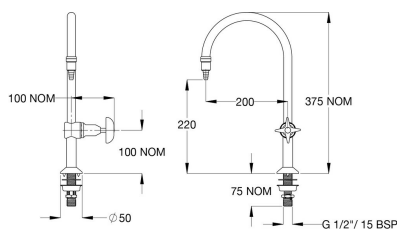

TW-LBSET-02

Lab Set Type 16 Swivel, Jumper Valve and Aerator Nozzle with Integral Mini Dual Check Valve.

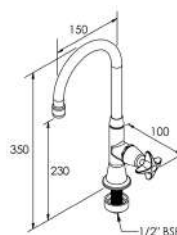

Laboratory Sets Type 13

Type 13 laboratory tapware is supplied standard with vandal resistant handle and button, 15mm male BSP inlet and standard jumper valve, finished with a heavy duty, bright chrome plating.



TW-LBSET-03

Lab Set H & C Mixing Unit Type 13 Swivel Outlet, Jumper Valves and #1 Aerator

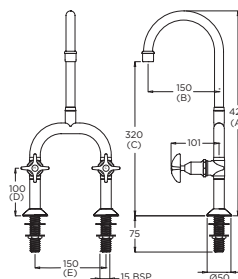

TW-LBSET-04

Lab H & C Mixing Unit Type 13 Swivel Outlet, Jumper Valves and #16 XT Tube Nozzle with Integral Mini Dual Check Valve.

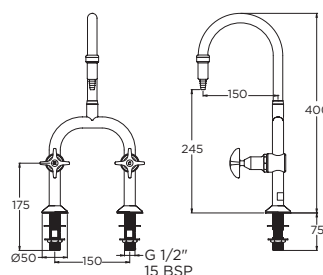

VISIT BRITEX.COM.AU TO DOWNLOAD BIM FILES, CAD DRAWINGS AND THE MOST CURRENT PRODUCT LITERATURE.



Due to ongoing research and our commitment to product development, details are subject to change without notice. Details accurate at time of print. Please refer to britex.com.au for the most current product information. Allow +/- 5mm tolerance for dimensions and setouts shown in product literature.

britex.com.au | sales@britex.com.au | A.B.N 83 004 309 737



Laboratory Sets Type 14

Type 14 laboratory tapware is supplied standard with vandal resistant handle and button, 15mm male BSP inlet and standard jumper valve, finished with a heavy duty, bright chrome plating.



TW-LBSET-06

Lab Set H & C Mixing Unit Type 14 Swivel Outlet, Jumper Valves and XT Tube Nozzle with Integral Mini Dual Check Valve on Spout and Bibs.

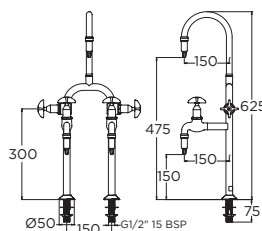

Laboratory Sets Type 19

Type 19 laboratory tapware is supplied standard with vandal resistant handle and button, 15mm male BSP inlet and standard jumper valve, finished with a heavy duty, bright chrome plating.



TW-LBSET-07

Lab Set H & C Mixing Unit Type 19 Swivel Outlet, Jumper Valves and #1 Aerator.

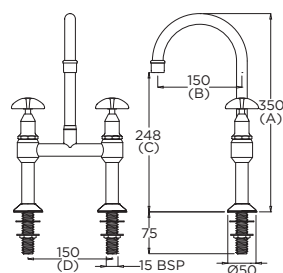

TW-LBSET-08

Lab H & C Mixing Unit Type 19 Swivel Outlet, Jumper Valves and XT Tube Nozzle with Integral Mini Dual Check Valve.

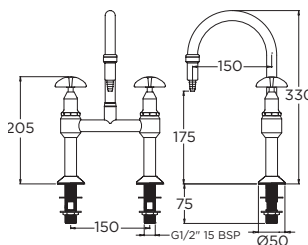

TW-LBSET-09

Lab Set Bib Cock Bench Mounted Type 26 (NSW School Specification)

AS/NZS 3718 approved. Commonly specified for NSW schools. Supplied with vandal resistant aerator, handle and button, 15mm male BSP inlet with anti-rotating pin on base and standard jumper valve. Bright chrome plate finish.

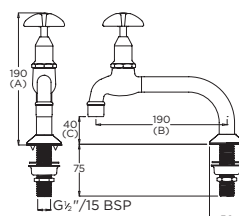

VISIT BRITEX.COM.AU TO DOWNLOAD BIM FILES, CAD DRAWINGS AND THE MOST CURRENT PRODUCT LITERATURE.

Last Revised Oct 2023