



Scan QR code to view online



Image shows model HBRE-TW-9201
Regal Basin with Deluxe Timed Flow Pillar Tap

features and benefits

- Flush mounts into bench top
- Grade 304 stainless steel
- Suitable for domestic and commercial
- Extended rear hob with tap hole
- Won't chip or break
- Satin finish
- 40mm waste outlet
- Supplied with fixing clips
- Choice of tapware models
- 35mm tap hole

about

The *BRITEX Stainless Steel Regal Basin* is manufactured from commercial grade 304 S.S and has a satin finish. Suitable for both domestic and commercial applications it comes supplied with fixing clips for installing in joinery benchtops. An extended rear hob includes a 35mm tap hole suitable for a range of tap styles. Supplied complete with 40mm waste outlet.

sample spec. text

BRITEX S.S. Regal Hand Basin - 520L x 430W x 150D. Satin finish stainless steel supplied complete with 35mm tap hole, 40mm waste outlet and XXXX tapware - Product Code HBRE-TW-XXXX

NB Please refer to reverse page for tapware and basin options

*RED TEXT may denote a variable where one option only is to be selected, a nominal dimension that needs to be specified, or an optional feature that can be removed if not required. Please refer to the back of this page for additional specification details and options.

VISIT BRITEX.COM.AU TO DOWNLOAD BIM FILES, CAD DRAWINGS AND THE MOST CURRENT PRODUCT LITERATURE.

REGAL BASIN

PRODUCT CODE

HBRE (Basin only)

HOW TO SPECIFY: Regal Basin

Sample Specification Code

A **B**
HBRE - TW-9201

= Regal Basin with Deluxe Timed Flow Pillar Tap

Specification Key

A = Product Code

B = Tapware (if required)
 (see below for suggested tapware options)

Suggested Tapware Options:

(see Tapware Section: 11 for complete range of options)



TW-9201
 Deluxe Timed Flow Pillar Tap



TW-9101
 Eco Timed Flow Pillar Tap



TW-9110
 Euro Basin Mounted Sensor Tap



TW-MIX-01
 Basin Mounted Flick Mixer

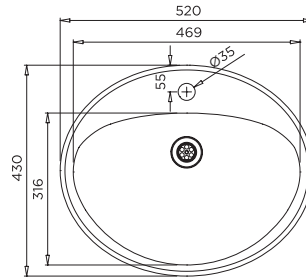

MODEL HBRE Plan

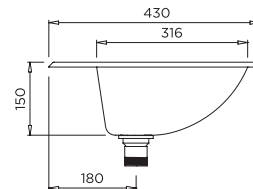

MODEL HBRE Side Elevation

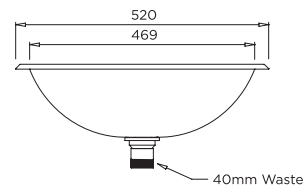

MODEL HBRE Front Elevation

When specifying this product please include:

- Product Name and Code
- Product Dimensions
- Tapware details (if required)



VISIT BRITEX.COM.AU TO DOWNLOAD BIM FILES, CAD DRAWINGS AND THE MOST CURRENT PRODUCT LITERATURE.

Last Revised June 2017



Due to ongoing research and our commitment to product development, details are subject to change without notice. Details accurate at time of print. Please refer to britex.com.au for the most current product information. Allow +/- 5mm tolerance for dimensions and setouts shown in product literature.

britex.com.au | info@britex.com.au | A.B.N 83 004 309 737

