



Scan QR code  
to view online



## features and benefits

- Three standard sizes
- Flush mounts into bench top
- Grade 304 stainless steel
- Satin finish
- 40mm waste outlet
- Suits top or under mounting
- Suits domestic and commercial applications

## about

*BRITEX Stainless Steel Inset Round Basins* are manufactured from commercial grade 304 stainless steel and have a satin finish. Stainless steel inset basins are suitable for both domestic and commercial applications and come in three standard sizes, complete with waste outlet. If desired, basins can be also be undermounted.

## sample spec. text

*BRITEX S.S. Inset Round Basin - XXXmm I.D. x XXXmm Deep. Satin finish grade 304 stainless steel supplied complete with 40mm waste outlet - Product Code HBHX*

\*RED TEXT may denote a **variable** where one option only is to be selected, a **nominal dimension** that needs to be specified, or an **optional feature** that can be removed if not required. Please refer to the back of this page for additional specification details and options.

VISIT [BRITEX.COM.AU](http://BRITEX.COM.AU) TO DOWNLOAD BIM FILES, CAD DRAWINGS AND THE MOST CURRENT PRODUCT LITERATURE.

# INSET ROUND BASIN

## PRODUCT CODE

**HBH1** Ø340 O/A x 150 mmD

**HBH2** Ø335 O/A x 115 mmD

**HBH3** Ø285 O/A x 100mmD

## HBH - dimensions

	A	B	C
HBH1	Ø340	Ø300	150
HBH2	Ø335	Ø300	115
HBH3	Ø285	Ø250	100

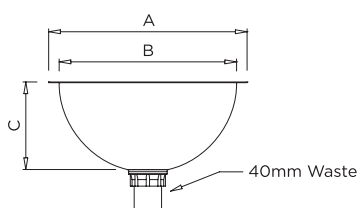

MODEL HBH Front Elevation

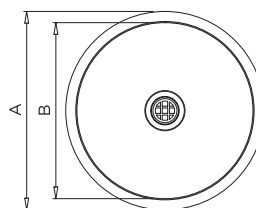

MODEL HBH Plan

specifying  
guide

*When specifying this product please include:*

- Product **Name** and **Code**
- Product **Dimensions**
- **Top** or **Under** Mounting

VISIT [BRITEX.COM.AU](http://BRITEX.COM.AU) TO DOWNLOAD BIM FILES, CAD DRAWINGS AND THE MOST CURRENT PRODUCT LITERATURE.

Last Revised June 2017