

Pull Chain Cistern



Scan QR code
to view our
installation notes



FCP



Product Info:

- Fully welded case with radius top edge
- Durable metallic pull chain
- Tamper resistant service panel
- Concealed wall fixings

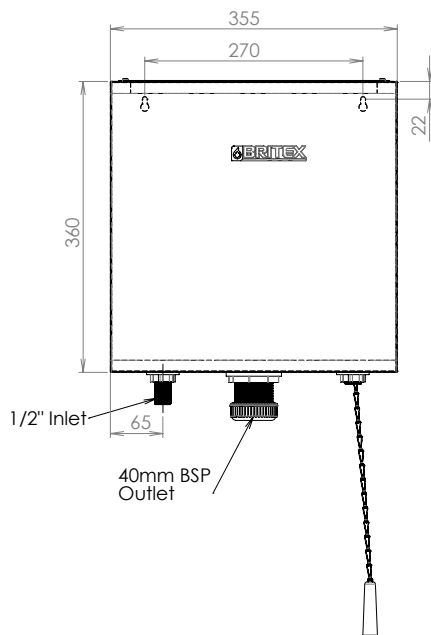

INSTALLATION NOTES

1) Cistern mounts to wall via two key hole fixings at the rear of the cistern case. 2) Fixing points are accessed by removing the access panel on top of the cistern. 3) Inlet is supplied on left hand side.



Due to ongoing research and our commitment to product development, details are subject to change without notice. Details accurate at time of print

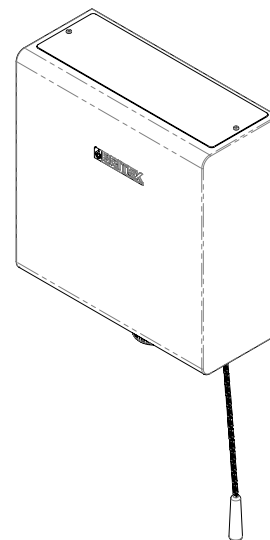
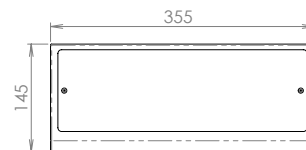
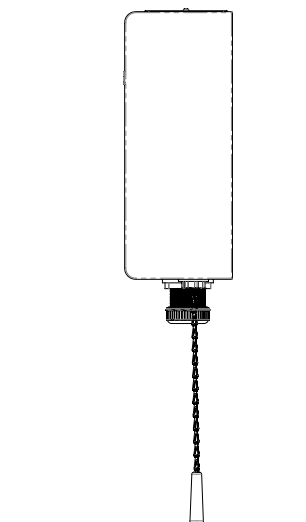

Please refer to britex.com.au for the most current product information. Allow +/- 5mm tolerance for dimensions and setouts shown in product literature.

Last Revised June 2017