

BENCHTECH 300mm WALL SHELF



features and benefits

- Made from 304 grade S.S
- Satin Finish
- 1.2mm Thick S.S.
- S.S. 'C Channel' Reinforcement
- Supplied with stainless wall brackets
- Easy to clean and maintain
- Suits wide range of project types

about

The Britex Stainless Steel Wall Shelf is manufactured from 1.2mm thick stainless steel in commercial grade 304 in a satin finish. The shelves are 300mm wide and are available in 4 standard sizes. Custom lengths to suit your application can also be manufactured (consult Britex). Providing absolute value for money, the BenchTech range is ideal for use in projects such as teaching kitchens, canteens, cafes and restaurants.

sample spec. text

Benchtech *XXXXmm* x 300mm D Wall Shelf - Product Code BT-WS-*XXX*

*RED TEXT may denote a **variable** where one option only is to be selected, a **nominal dimension** that needs to be specified, or an **optional feature** that can be removed if not required. Please refer to the back of this page for additional specification details and options.

VISIT BRITEX.COM.AU TO DOWNLOAD BIM FILES, CAD DRAWINGS AND THE MOST CURRENT PRODUCT LITERATURE.



MELBOURNE
Britex Place, Mirra Crt
Bundoora VIC 3083
t (03) 9466 9000
f (03) 9466 9011

SYDNEY
16 Northumberland Drv
Taren Point NSW 2229
t (02) 9531 2100
f (02) 9531 2800

PERTH
Unit 1/8 Principal Link
Malaga WA 6090
t (08) 9249 5464
f (08) 9248 6893

BRISBANE
19 Manilla St
East Brisbane QLD 4169
t (07) 3363 2400
f (07) 3363 2444

ADELAIDE
The Britex Group
SA State Office
t 1300 764 744
f 1300 784 306

britex.com.au | sales@britex.com.au | A.B.N 83 004 309 737

BENCHTECH 300mm WALL SHELF

PRODUCT CODE

BT-WS-309 900mm L x 300mm W

BT-WS-312 1200mm L x 300mm W

BT-WS-315 1500mm L x 300mm W

BT-WS-318 1800mm L x 300mm W

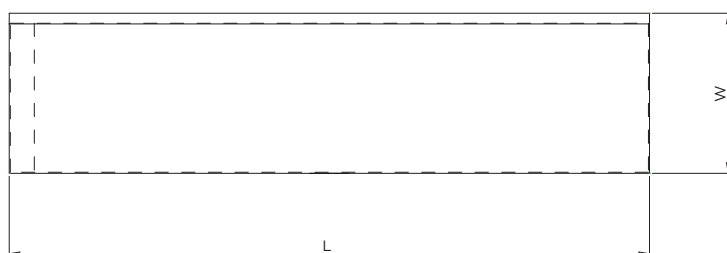

MODEL BT-WS Plan

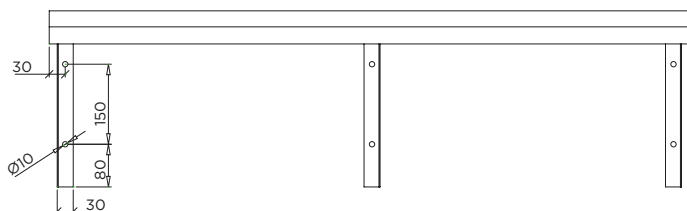

MODEL BT-WS Front Elevation

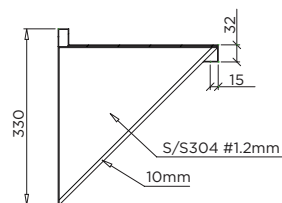

MODEL BT-WS Section

specifying
guide

When specifying this product please include:

- Product **Name** and **Code**
- Product **Dimensions**

options

- Product Length - Available in: 900mm, 1200mm, 1500mm, 1800mm Standard Lengths

VISIT BRITEX.COM.AU TO DOWNLOAD BIM FILES, CAD DRAWINGS AND THE MOST CURRENT PRODUCT LITERATURE.

Last Revised Apr 2023