

Scan QR code  
to view online



## features and benefits

- Made from 25x25mm grade 304 S.S tube
- Manufactured to custom lengths
- Fully customisable
- Supplied with stainless wall brackets
- Sealed tube ends
- Easy to clean and maintain
- Heavy duty welded construction
- Particularly suited to commercial kitchens

## about

The *BRITEX Stainless Steel Square Tube Shelf* is manufactured from heavy duty 25 x 25 x 1.2mm tube in commercial grade 304 stainless steel. Shelves are manufactured in custom lengths to suit each application and are typically 325mm wide overall with sealed tube ends. Fully customisable, tube shelves are supplied complete with square stainless steel tube brackets and are particularly suited to commercial kitchen applications for storing and drying kitchen pots and pans.

## sample spec. text

*BRITEX Stainless Steel Square Tube Shelf - 25x25x1.2mm grade 304 S.S. XXXX mm Long x 323mm Wide O/A. Supplied complete with stainless steel wall brackets. Tube ends to be sealed - Product Code SHELF-T*

\*RED TEXT may denote a **variable** where one option only is to be selected, a **nominal dimension** that needs to be specified, or an **optional feature** that can be removed if not required. Please refer to the back of this page for additional specification details and options.

VISIT [BRITEX.COM.AU](http://BRITEX.COM.AU) TO DOWNLOAD BIM FILES, CAD DRAWINGS AND THE MOST CURRENT PRODUCT LITERATURE.

# SQUARE TUBE SHELF

PRODUCT CODE

## SHELF-T

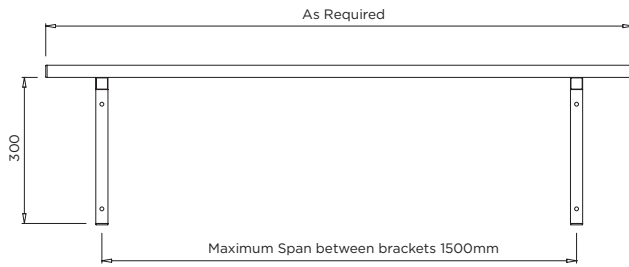

MODEL SHELF-T Front Elevation

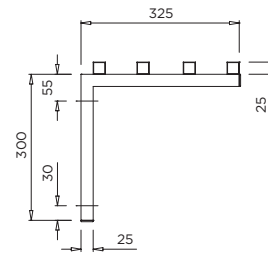

MODEL SHELF-T Side Elevation

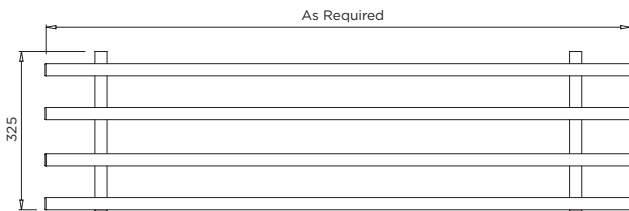

MODEL SHELF-T Plan

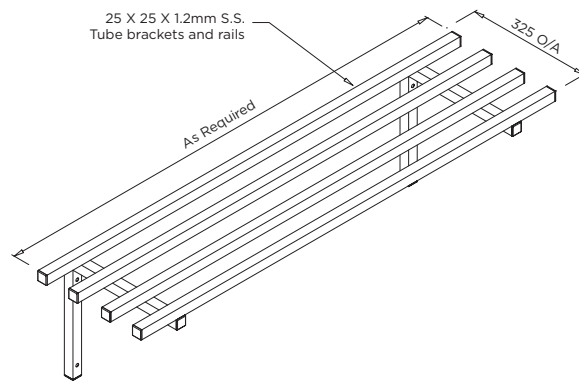

MODEL SHELF-T Isometric View

*When specifying this product please include:*

- Product **Name** and **Code**
- Product **Dimensions**

specifying guide

options

- Custom shelf length and width
- Multi layer shelving

VISIT [BRITEX.COM.AU](http://BRITEX.COM.AU) TO DOWNLOAD BIM FILES, CAD DRAWINGS AND THE MOST CURRENT PRODUCT LITERATURE.