

WALL MOUNTED CLEANER'S BENCH

7.15

COMMERCIAL SINKS

#CCB / WALL MOUNTED CLEANER'S BENCH



Scan QR code
to view online



features and benefits

- OH&S friendly design
- Grade 304 S.S. hinged bucket grate
- Integral drainer board/storage space
- Standard and custom sizes available
- Extra large 54L bowl capacity
- Grade 304 or 316 stainless steel
- Fully welded, seamless construction
- Satin finish
- 50mm waste outlet
- Stainless wall brackets supplied
- Adjustable front legs
- Left or right hand bowl
- Suits health projects and cleaner's rooms

about

The *BRITEX Stainless Steel Wall Mounted Cleaner's Bench* is ideally suited to cleaner's rooms in health projects. It consists of a bucket sink with a robust stainless steel hinged grate and a drainer section for additional storage space. Designed by specialised health project architects, this cleaner's bench is OH&S friendly and extremely sturdy, mounted on rear wall bracket with added support provided by adjustable front legs. Can be supplied in standard and custom sizes and in commercial grade 304 or acid resistant grade 316 stainless steel.

sample spec. text

*BRITEX S.S. Wall Mounted Cleaner's Bench - 1.2mm Grade **304/316** Stainless Steel. 1100L x 550W O/A with 100mm splashback. Legs to front complete with adjustable feet. **Left/Right** hand 54L bowl to be complete with stainless steel hinged bucket grate and 50mm waste outlet - Product Code CCB*

*RED TEXT may denote a **variable** where one option only is to be selected, a **nominal dimension** that needs to be specified, or an **optional feature** that can be removed if not required. Please refer to the back of this page for additional specification details and options.

VISIT BRITEX.COM.AU TO DOWNLOAD BIM FILES, CAD DRAWINGS AND THE MOST CURRENT PRODUCT LITERATURE.



MELBOURNE
Britex Place, Mirra Crt
Bundoora VIC 3083
t (03) 9466 9000
f (03) 9466 9044

SYDNEY
16 Northumberland Drv
Taren Point NSW 2229
t (02) 9531 2100
f (02) 9531 2800

PERTH
Unit 1/8 Principal Link
Malaga WA 6090
t (08) 9249 5464
f (08) 9248 6893

BRISBANE
19 Manilla St
East Brisbane QLD 4169
t (07) 3363 2400
f (07) 3363 2444

ADELAIDE
The Britex Group
SA State Office
t 1300 764 744
f 1300 784 306

britex.com.au | info@britex.com.au | A.B.N 83 004 309 737

WALL MOUNTED CLEANER'S BENCH

PRODUCT CODE

CCB

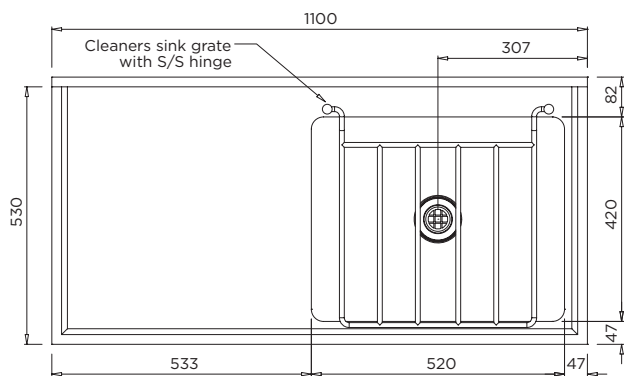

MODEL CCB Plan

Suggested Tapware:

(see Tapware Section: 11 for complete range of options)



TW-SET-01
Wall Sink Set
with Fixed Spout



TW-SET-04
Wall Sink Set
with Upswept
Swivel Spout



TW-SET-05
Wall Sink Set
with Gooseneck
Swivel Spout



TW-MT-54FC1
Wall Mounted
Mixing Unit

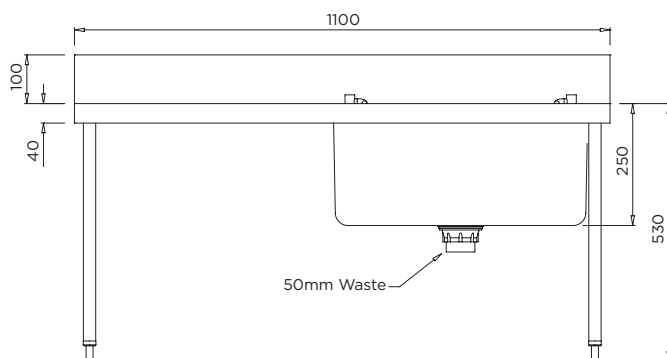

MODEL CCB Front Elevation

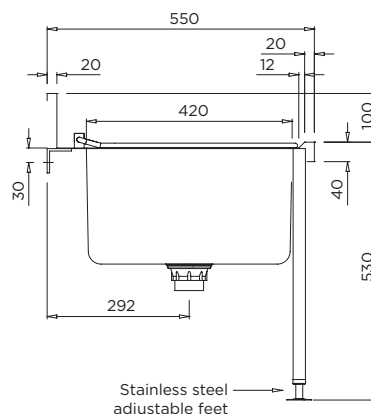

MODEL CCB Side Elevation

specifying
guide

*When specifying this
product please include:*

- Product **Name** and **Code**
- Product **Dimensions**
- **Bowl** Position (left or right)
- **Grade** of Stainless Steel (304 or 316)

options

- Grade 304 or 316 S.S.
- Custom sizes
- Supplied without grate
- Left or right hand bowl position
- Square legs with adjustable high impact nylon feet
- Grade 316 S.S. Waste - LSPW: p.7.07

VISIT BRITEX.COM.AU TO DOWNLOAD BIM FILES, CAD DRAWINGS AND THE MOST CURRENT PRODUCT LITERATURE.