

SHOWER COLUMNS

FEATURES;

- Fully hand made.
- Vandal resistant.
- Flushmount or buried base.
- "Water Saving" shower.
- Fully plumbed.
- Time flow tapware



BSC

BRITEX Shower Columns are available in round or square styles with single or multiple outlets to suit your preferences or requirements. Both styles share similar dimensions, sturdy construction and vandal proof fittings. As with all Britex products, the shower column is also supplied with water saving features, resulting in a robust, efficient, and attractive product.

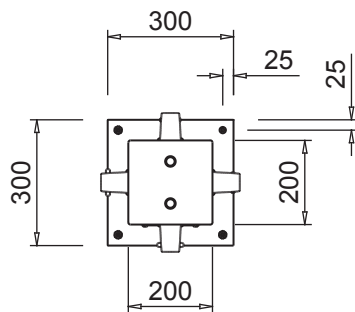
PRODUCT CODES:**BSCS1 - 1 HEAD SQUARE****BSCS2 - 2 HEAD SQUARE****BSCS3 - 3 HEAD SQUARE****BSCS4 - 4 HEAD SQUARE****BSCR1 - 1 HEAD ROUND****BSCR2 - 2 HEAD ROUND****BSCR3 - 3 HEAD ROUND****BSCR4 - 4 HEAD ROUND**

PLAN - CSS4

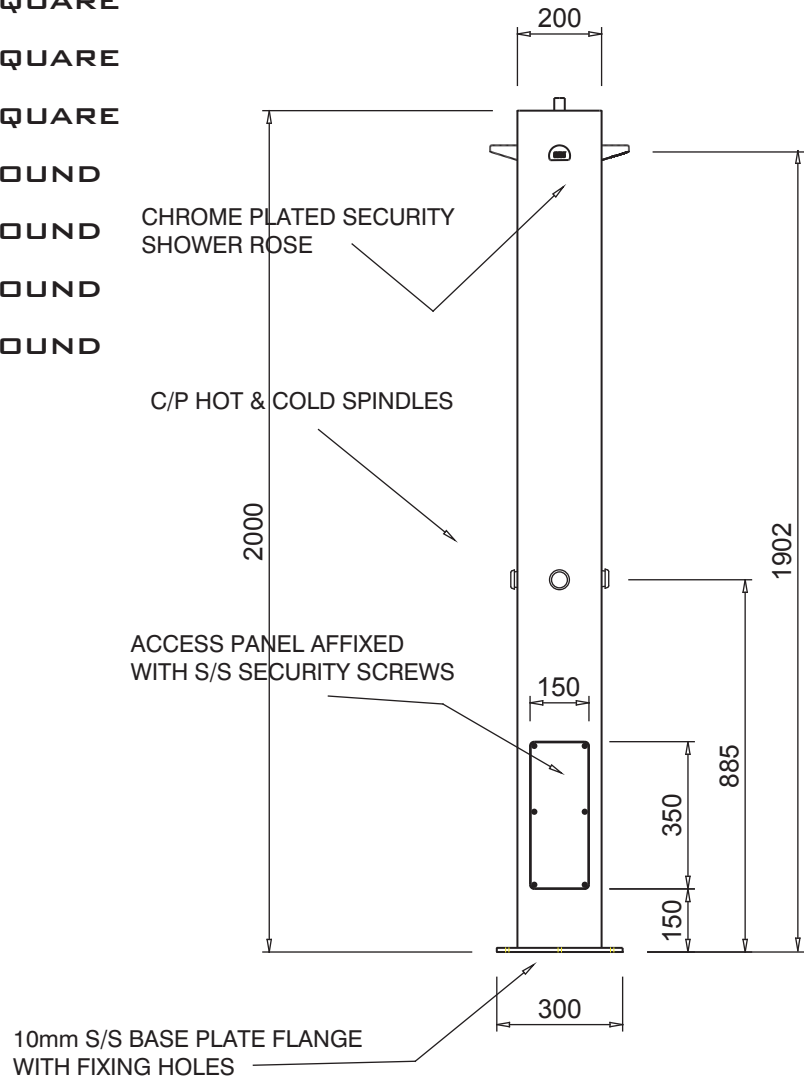

ELEVATION - CSS4

BSC**SPECIFICATIONS**

When specifying this product, please include the following details;

- Product **Name** and **Model No.**
- Product **Features.**

OPTIONS

- Flush or buried mount.
- Water entry.
- Tapware.

Melbourne
 Britex Place, Mirra Court
 Bundoora
 Victoria 3083
 Telephone 1300 764 744
 Fax (03) 9466 9044

Sydney
 Unit 11, 16-18 Northumberland Rd
 Taren Point
 New South Wales 2229
 Telephone 1300 764 744
 Fax (02) 9531 2800



BRITEX
 STAINLESS STEEL FABRICATED PRODUCTS

SINCE 1938

www.britex.com.au

e-mail info@britex.com.au
 A.B.N. 83 004 309 737

Represented in all states of Australia, throughout Asia and the Pacific Regions.
 All product manufacturing by **BRITEX** can be adapted to suit your special application.
 Allow 5mm tolerance for setout dimensions given in these drawings. Details accurate at time of print.
 As **BRITEX** is always committed to improving on design and quality, it is possible that some details may alter without notice.